



**Specifications for the reception of the public on racetracks
from Monday, January 24, 2022**

These specifications are binding on any racing company having to organise a race meeting (national or local) from Monday 24 January 2022 until further notice.

Summary

- 1) General principles
- 2) Control of the vaccine pass for access to the racecourse
- 3) Mandatory security measures

1) General principles

In accordance with the provisions set by the Government (Decree No 2022-699 of 01 June 2021 prescribing the general measures necessary to manage the outcome of the health crisis, as amended by Decree No. 2022-51 of 22 January 2022), the horse racing sector adapts the conditions for the reception of the public on racetracks as from Monday 24 January 2022.

- **The total number of people may not exceed 5,000 people on racetracks (including 2,000 people in the same indoor area).**
Organizers and competitors are not considered in this workforce, as they occupy specific spaces on the racetrack.
- Use of facemasks (with 90% filtration efficiency or surgical, in perfect integrity) **is mandatory in all indoor and outdoor spaces** (see page 3). Placing the mask over your nose and mouth **for 6-year-old or older persons**.
- For **all persons aged at least 16 years** of age, regardless of their status or function, the presentation of a **valid vaccination pass** is mandatory for access to the racecourse.
- **Persons who are at least 12 years old and under 16 years old** are not required to present a vaccine pass but must submit a negative result for antigen or PCR test or proof of recovery from COVID-19 (see page 3).
- **Other health security measures continue to be imposed with the greater rigor:**
 - permanent reminder of compliance with barrier gestures and in particular the safety distance (1 m),
 - organization adapted for sensitive work areas (weighing room, changing room, infirmary, veterinary office, etc.),
 - **catering open in accordance with the provisions set at national level (see § 3.5 page 5).**

The public is invited to download and activate the “All Anti-Covid” application.

Specific measures may be set by the Prefectures within each department.

2) Control of access to the racecourse

2.1 Any **person who is at least 16 years** of age accessing the racecourse (public, volunteers, employees, providers, partners, socio-professionals) must have a **valid vaccination pass**. This is mandatory regardless of the mission or location occupied.

What form can the vaccine pass take and what information is included?

The vaccine pass can be presented in paper or digital format.

If digital format, this can be via the “TousAntiCovid” mobile application or any other digital medium at the choice of the data subject.

The information to be included is as follows:

- Surname, first names and date of birth,
- A code corresponding to one of the required supporting documents concerning the health situation of the person.

Who is authorised to control the vaccine pass?

Each Racing Society must empower individuals authorised to control the vaccine pass by name: a register shall specify the list of authorised persons, the date of their authorisation and the days and times of checks carried out by each person.

Authorised persons must be informed that the data checked must not be recorded, in the context of the protection of personal data.

How to control the vaccine pass

Vaccine pass control is carried out via the “Tousanticovid Verif” app, which can be downloaded free of charge on a smartphone.

The control teams must read the QR code presented by the person wishing to access the racecourse via the “AllAntiCovid Verif” application: the person can access only if the result of the reading is valid.

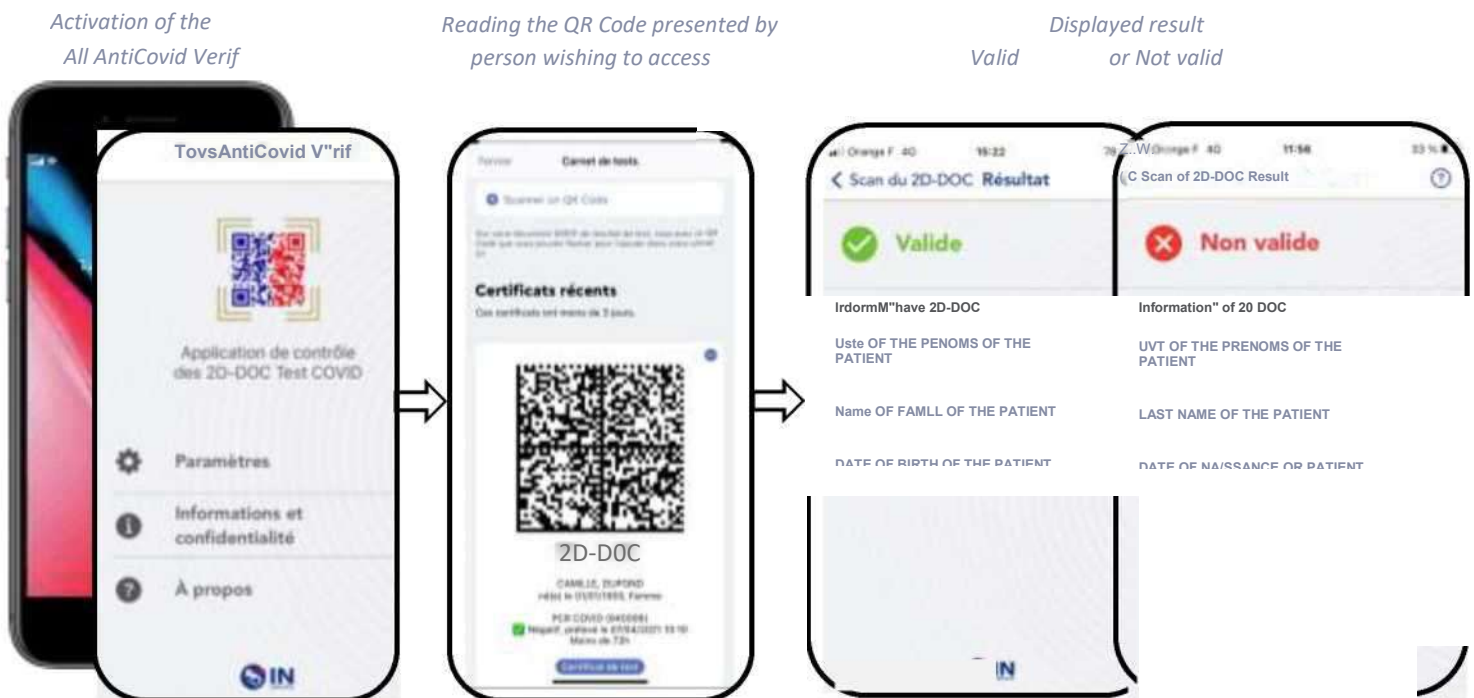

The data checked on this occasion is not stored by the application “All Anti Covid Verif”, it is only read during the inspection.

The vaccination pass of the socio-professionals accompanying the horses can be checked either at the access of the trucks in the car park or at the access of people in the stables, to avoid depending on the configuration of the racecourse possible traffic jams on the public road.

Control teams may ask any person wishing to access the racecourse to produce an official document containing his or her photograph, if there are serious reasons to believe that the vaccine pass presented does not relate to that person.

Information for the public is displayed at the entrances of the racecourse (a poster model proposed by the FNCH).

2.2 Any person who is at least 12 years of age and under 16 years of age must, in the absence of a vaccine pass, have:

- the negative result of a screening test carried out less than 24 hours before access to the racecourse, or
- a certificate of recovery following contamination with covid-19.

3) Mandatory security measures

Among the organisers must be designated:

- a senior referent Covid 19, responsible for monitoring the application of these specifications and privileged contact with the authorities — it is recommended that this person be separate from the safety manager of the racing company, given the numerous requests that might keep him away from the running of the races.
- persons specifically in charge of re-supply during the meeting with disinfectant equipment (hydroal alcohol gel, disinfectant wipes — see §3.3).

3.1) cleaning and disinfection of premises before, during and after the race meeting

Thorough cleaning and disinfection with detergents — disinfectants that meet the virucid standard — are imperative before the access of stakeholders to the site, after the race meeting and during the meeting when this does not disrupt the respect of distances between people.

This applies especially to door and window handles, stair ramps, railings, elevator buttons, as well as sanitary and catering areas.

A periodic cleaning service plan must be developed according to the activity schedule of the site, with each cleaning and disinfection operation recorded in a document that can be submitted in case of control.

3.2) wearing the mask on the racetrack

Any person 6 years of age or older entering the racecourse must wear a mask that meets the applicable standards, covering the mouth and nose.

In accordance with the sanitary provisions, which stipulate that the wearing of the mask is compulsory except for the practice of sporting activities, and in accordance with the recommendations of the doctors councils of the Mother Societies, the wearing of the mask, which is mandatory at all times on the racetrack, is recommended only for competitors from the start of the track and until they leave the track.

3.3) communication on barrier gestures and provision of hydroalcoholic gel and disinfectant wipes

From access to the site and in all accessible spaces, **posters** must remind of the imperative barriers, the obligation for everyone to wear a mask and the measures of social distancing (models of posters will be broadcast by the FNCH).

Micro announcements must be made at regular intervals during the meeting, to recall the respect of the gestures barriers and to invite the public to spread over the large space of the racecourse.

As soon as access to the site, bottles of hydro-alcoholic gel must be made available.

For fixed workstations with contact surfaces (tables, countertops), gel and disinfectant wipes must be made available.

This equipment must be put in place before the arrival of the workers. They must be replenished if necessary during the meeting.

3.4) sensitive spaces

Ventilation of the premises by natural or mechanical ventilation (open doors and windows) is carried out as much as possible, ideally permanently if conditions allow and at least several minutes every hour.

- **Betting counters**

Access to the premises of the pari-mutuel and in particular to the distribution office is strictly limited to the staff in charge of the racecourse pari-mutuel betting (CARRUS or PMU group).

Where the location configuration allows, if more than one access to the distribution office is available, one access must be dedicated to the entrance and another dedicated access to the exit, in order to limit crossings.

A height bend must indicate these rules.

Betting terminals can be left accessible provided that the keyboard is cleaned regularly and hydro-alcoholic gel is available nearby.

Payment by contactless credit card must be preferred.

In front of the stationary playgrounds and in front of the odds display screens, ground markings must be materialised to ensure that a distance of 1 m between each person is respected.

- **Children's games**

Fixed, permanent playgrounds must be left accessible under the responsibility of the parents. The event playgrounds, with the presence of an animator (e.g. inflatable games rides, ponies, etc.) must be left accessible, with if necessary limitation under the control of the facilitator of the number of children accessing it simultaneously.

For all playgrounds, hydroalcoholic gel must be made available nearby.

- **Guided tours**

Outdoor guided tours can be organised by limiting the number of participants to 10 people.

During the visit, the facilitator should remind participants to keep their masks at any time, including during exchanges, and to respect a distance of 1 m during the walk and at each stop.

- **Promotional follower cars for partners**

Promotional followers are allowed.

- **The infirmary**

Infirmaries are often small premises: access within the infirmary must be authorised only with the agreement of the doctor in the event of an emergency. The room must be continuously ventilated.

Any other non-emergency reason must be treated outside the infirmary. A dais or a screen may be set up and a ground marking indicating a confidentiality zone must be put in place.

Any person who develops symptoms during the meeting should immediately consult the duty doctor. In the absence of a sign of distress, the person must return to his/her home by isolating himself and excluding public transport, and contact his doctor immediately.

3.5) catering

The catering offer must comply strictly with the provisions in force established by the Government for this activity:

- Opening of the indoor rooms and outdoor terraces at 100 % of their capacity,
- **No consumption at the counter: take-away sale or consumption at the table,**
- Wearing the mask required in the catering areas, except at the table for the time of the meal.

Since the vaccine pass has already been checked during access to the racecourse for all people without exception, a second check by the restaurateur is not necessary when accessing the catering area.

3.6) events outside shopping days

For events outside racing days, racing companies must contact their prefecture on a case-by-case basis to assess the feasibility of the event.

When these events are open to the public, vaccination pass control is mandatory.